



<http://www.paducahvision.com>

The screenshot shows two browser windows. The left window, titled 'Welcome', contains a 'Project History' section with text about the Kentucky Research Consortium for Energy and Environment (KRCEE) at the University of Kentucky. Below the text is an image of a landscape with a large sign that says 'WELCOME to the'. The right window, titled 'Scenarios', contains a link 'View the scenarios here' with a book icon, the word 'OR', and a link 'Take the scenario survey' with a green checkmark icon and a red arrow pointing down.

[1] If you take click on “Take the scenario survey” you will be guided through a series of slides that will 1) ask you some demographic questions, 2) explain each of the 12 scenarios, 3) ask you to provide a suitability score (1 to 9) for each of the scenarios, 4) ask your input on additional scenarios, 5) solicit your own scenarios, and 6) ask you to evaluate the process.

[2] You can use the slider bar on the right side of your computer screen to move through the slides

[3] At the end of each presentation, click on the bottom arrow box to advance the presentation.



[4] After the opening slide of the scenario survey, each page will have an accompanying dialogue box, that will provide supporting audio. You can begin the audio by clicking on the first button. Use the slider bar of the computer screen to advance through the slides as the audio plays.

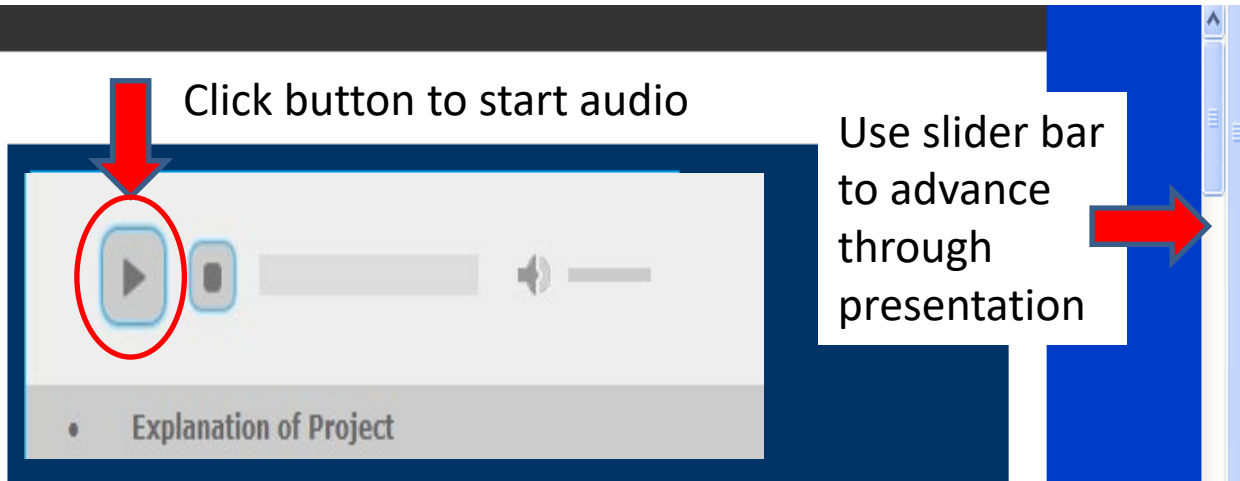

[5] At different points in the presentation you will be asked to provide Feedback. This can be done in two different ways:

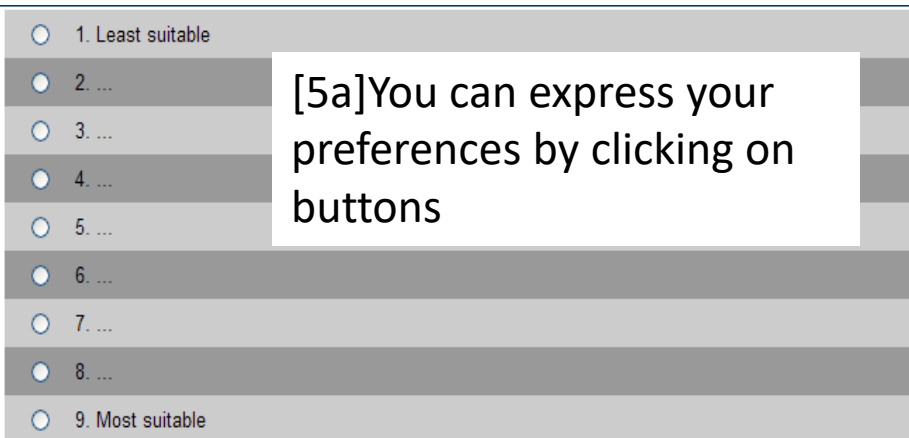

Please provide any questions or comments you may have about either of these scenarios.

[5b] You can express your opinion through dialogue boxes

You can move backward or forward through the presentation by using the arrow boxes at the bottom of each series of slides

